

Changes in the Latest Update of SkyDesk Reports

December 2016



Fuji Xerox Co., Ltd.
SkyDesk Service Center

Summary

Thank you for using SkyDesk Reports. We greatly appreciate your business.

We provide several new features and enhancements for SkyDesk Reports.

This document explains the important changes in order to make your transition easier.

1. The Column Width Ratio for Export as PDF
2. Introduction of the Variables feature
3. Enhancements of the User Filters function
4. Introduction of the Bubble Charts function (beta versions)

1. The Column Width Ratio for Export as PDF

- When exporting reports (Pivots, tabular View, and Summary View) in PDF format, users can choose between two setting options for column width ratio.

Before: there was only one setting option available for column width ratio: [Equal width for all columns].

After: users can choose between the two options: [Equal width for all columns] and [Proportionate width as in the report].

The screenshot shows the 'Export as PDF: Settings' dialog box. The 'Column Width Ratio' dropdown menu is highlighted with a purple box, and the 'Proportionate width as in the report' option is selected and highlighted in blue. Other settings include: File Name: Column Width Ratio; Language: Japanese; Paper Size: Auto (Sized by Column count); Orientation: Portrait (selected); Include Title: At Top; Include Description: At Top.

2. Introduction of the Variables feature

- The Variables feature is introduced in the latest update. This function enables users to specify data in a report available to each user when the users share a report with other users.
- A user can create or edit variables in the [Settings] page > the [Variables] tab. In a dialog box for sharing reports, the user can specify the variables as filtering criteria.

Original view

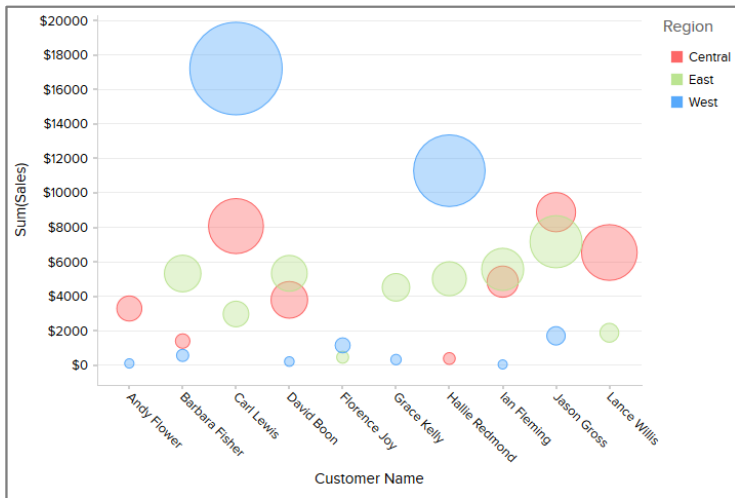

Specify Filter Criteria using Variable, and share the view



Shared view for user A

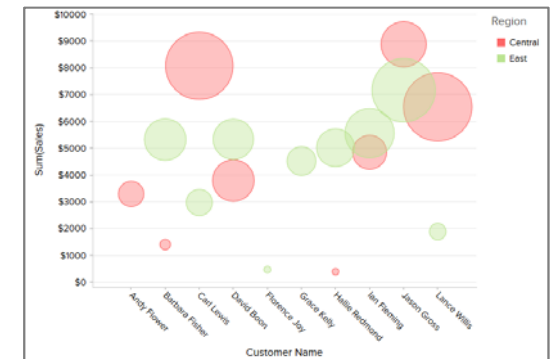

Shared view for user B

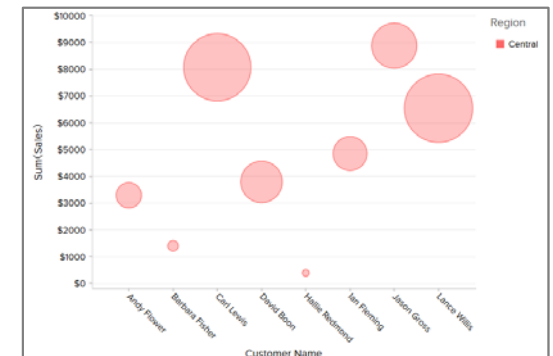

3. Enhancements of the User Filters function (1) exclusion of reports from being filtered

- Users can choose a report in the Dashboard so that user filters are not applied to the report.

Before: All selected filters are applied to all reports displayed in the Dashboard.

After: Users can choose to which reports the user filters are applied to.

- To exclude a report from being filtered, click the gear icon of the report in the Report Designer screen and tick the [Exclude Dashboard Filters] option.

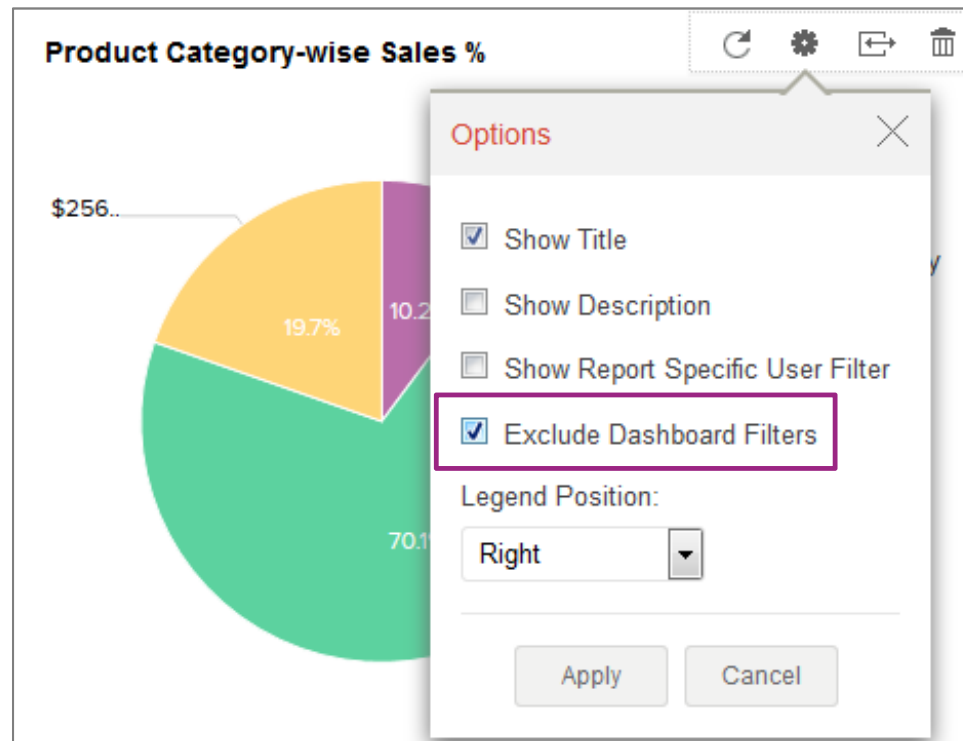

3. Enhancements of the User Filters function (2) the default setting of the Timeline Filter

- Users can set one of the selected filters as a default filter for the Timeline Filter.

Before: when the Dashboard screen is displayed, the filters are not applied to the Dashboard.

After: when the Dashboard screen is displayed, the filter that is set as a default filter is applied to the dashboard.

- In order to set the default filter value, click the gear icon of the Timeline Filter and select a filter shown in the dialog.

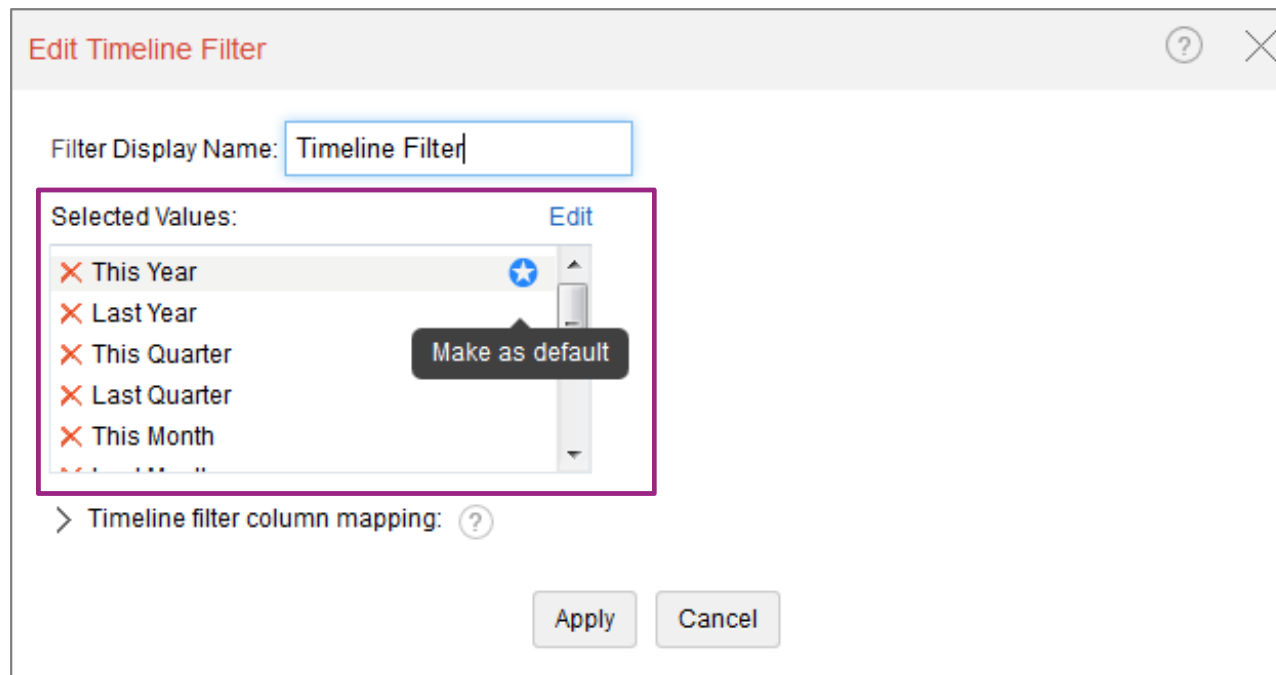

3. Enhancements of the User Filters function

(3) the Mapping of the Timeline Filter

- When a report is created based on a file having more than one date column, a user can specify the date column to be applied to the Timeline Filter. The date column to be applied can be specified for each report.

Before: the date column to be applied to the Timeline Filter is automatically selected by the system.

After: the date column to be applied to the Timeline Filter can be chosen by users.

- To specify the date column, click the gear icon of a report on the Report Designer screen and select the column of dates from the pull-down list of the [Mapping Timeline Filter] option.

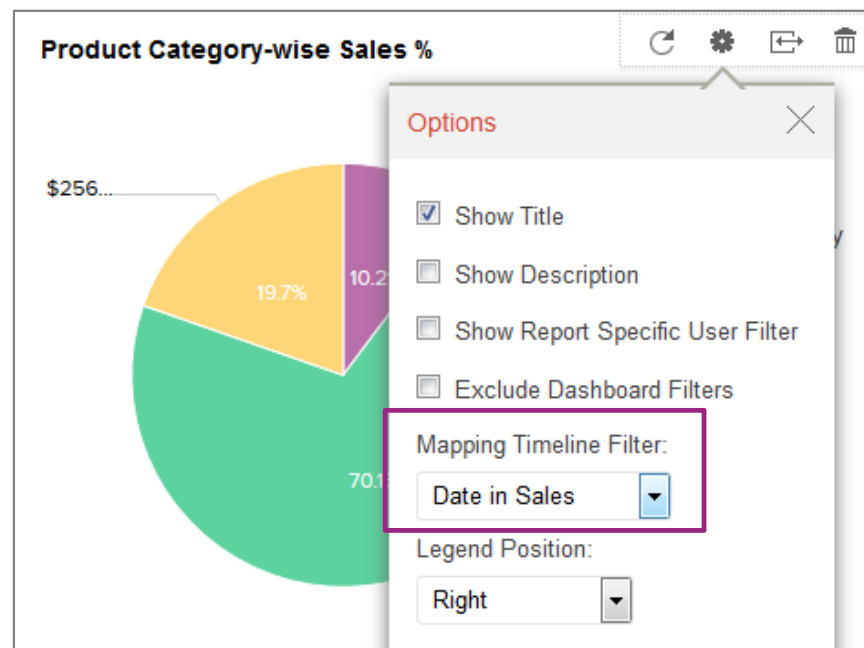

4. Introduction of the Bubble Charts function (beta versions)

- The Bubble Chart function is added as a new function of SkyDesk Reports.
- In order to use the Bubble Charts function, users need to click the “Try new chart” link to change the screen to the beta version of SkyDesk Reports.

